

# SERIE CORREDERA G90

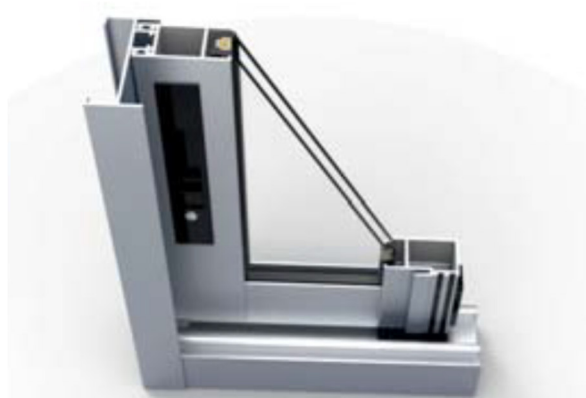

## Características Técnicas

- **Aleación de Extrusión:**  
-6060
- **Estado de Suministro :**  
-T6
- **Dimensiones:**  
-Marco de 70mm y hoja 28mm, Tricarril 104,5  
-Corte recto a 90º
- **Tipo de estanqueidad al Aire-Agua:**  
-doble junta de hilado de polipropileno en la hoja  
-cortavientos superior e inferior  
-desagüe interior marco
- **Tipos de Tapajuntas:**  
-Clipado mediante clips de poliamida autodesmontable con junta de remate.
- **Accesorios:**  
-Ensamblajes con escuadras, tacos y tornillos. Escuadras de alineamiento metálicas
- **Hueco de Acristalamiento:**  
-La periferia permite vidrios de hasta 18mm
- **Estética:**  
-acabado recto minimalista
- **Tratamiento superficial:**  
-Lacado: Con certificación QUALICOAT  
-Anodizado: Con calidad QUALANOD
- **Herrajes:**  
-cierre embutido o multipunto  
-ruedas metálicas regulables

## Ensayos y Prestaciones

Aire	Agua	Viento	Térmica®	Acústica
clase2	clase5A	claseB3	3,93 w/m²K	28(-1;-2)db

\*Ventana de 1400x1600 2 hojas .

Permeabilidad Aire:	UNE-EN 1026:2000
Estanqueidad al Agua:	UNE-EN 1027:2000
Resistencia al Viento:	UNE-EN 12211:2000
Aislamiento Acústico:	UNE-EN 140-3:1995
Transmisión Térmica:	UNE-EN ISO 10077-2:2008

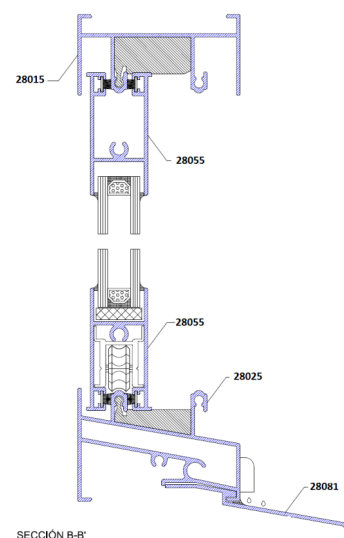

# SISTEMAS DE CARPINTERIA

## PRACTICABLES CANAL EUROPEO

### Con Rotura de Puente Térmico

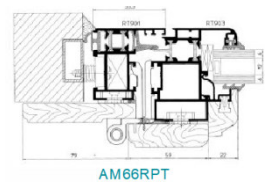
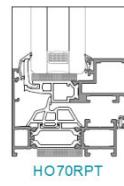
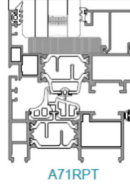
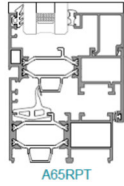
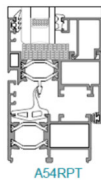
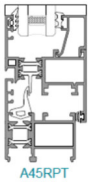

### Sin Rotura de Puente Térmico

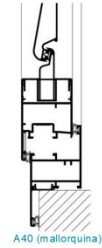
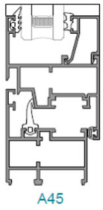

## CORREDERAS

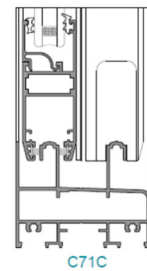
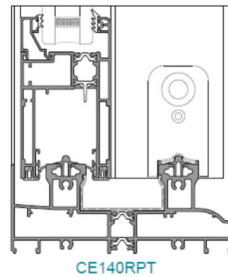
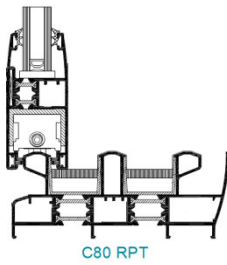
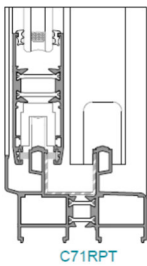

## SOLUCIONES PARTICULARES

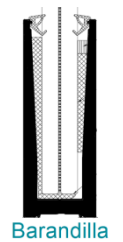
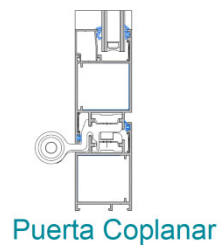
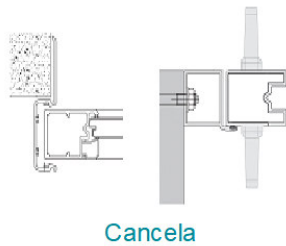
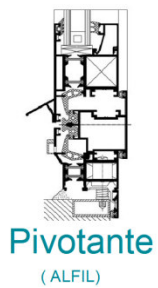

## SISTEMAS DE FACHADAS

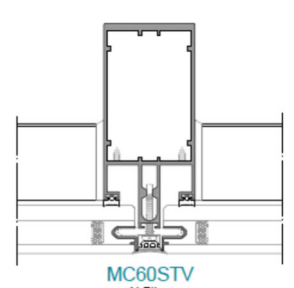
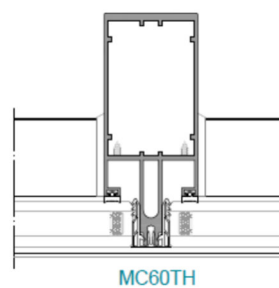
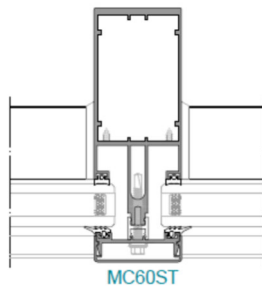
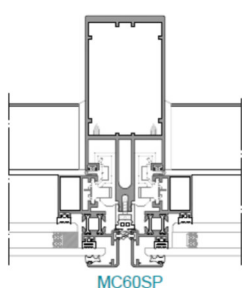
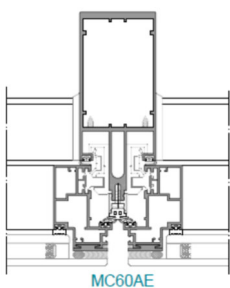

MARCOS

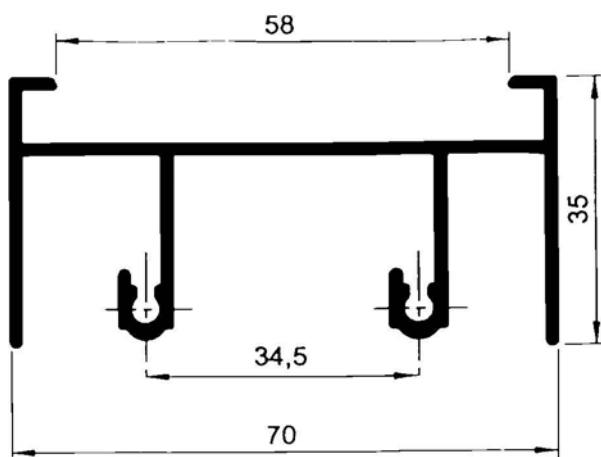

28015 MARCO SUPERIOR

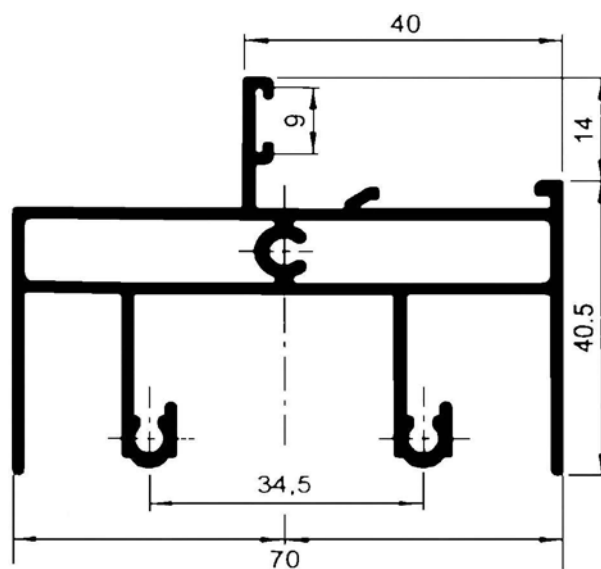

28105 MARCO SUPERIOR CON FIJO

**CORREDERA G-90**

norperfil

MARCOS

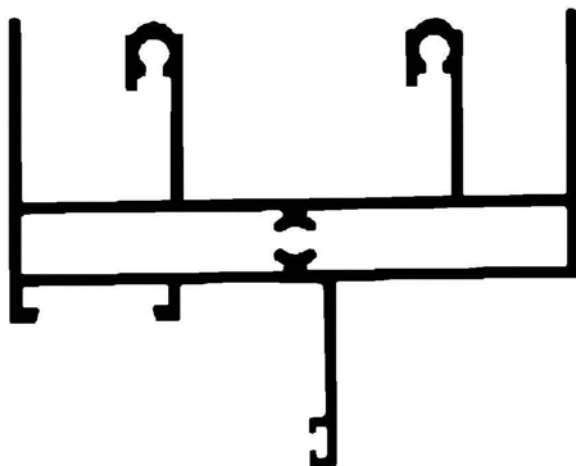

**CMD229** MARCO SUPERIOR C/FIJO C.EUROPEO

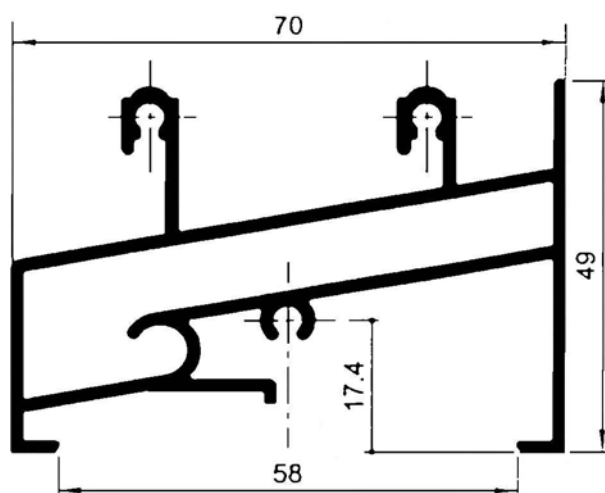

**28025** MARCO INFERIOR

MARCOS

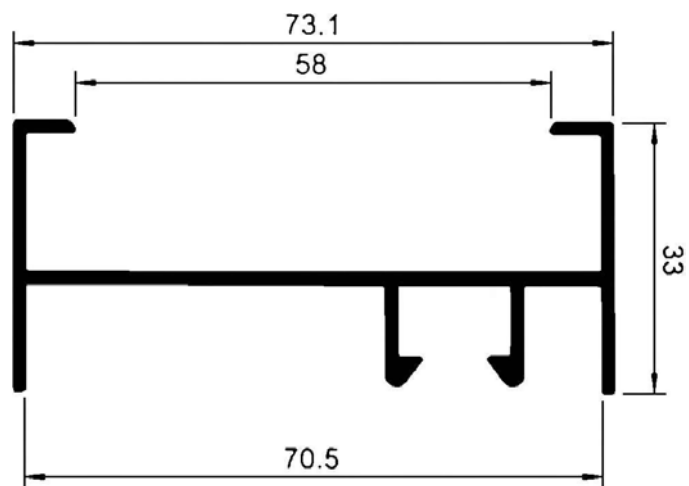

**28035** MARCO LATERAL LISO

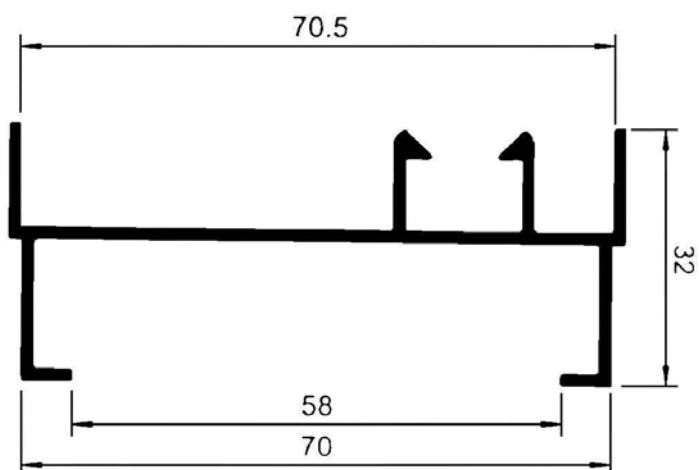

**28007** MARCO LATERAL RESALTE

MARCOS

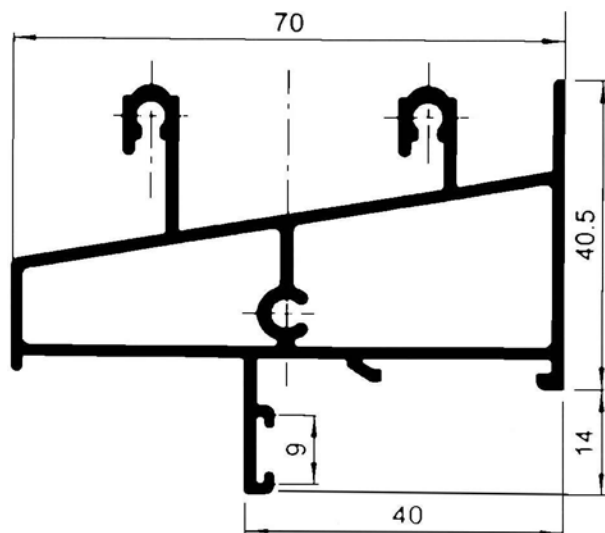

28115 MARCO INFERIOR CON FIJO

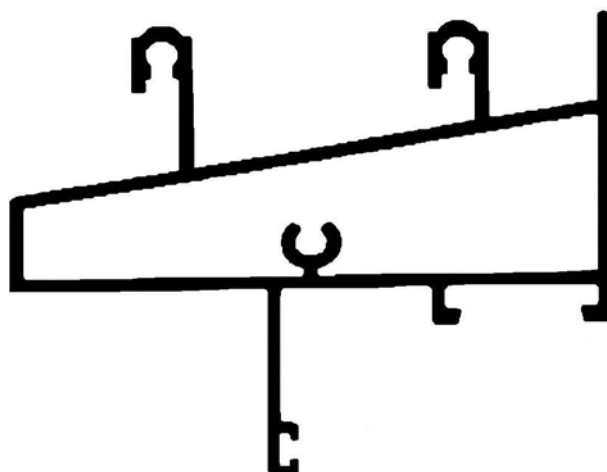

CMD200 MARCO INFERIOR C/FIJO C.EUROPEO

MARCOS

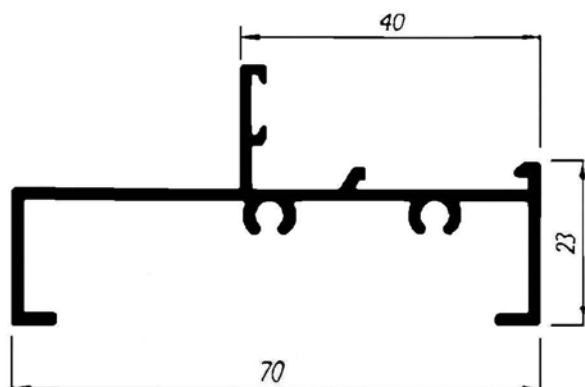

28155 MARCO FIJO LISO

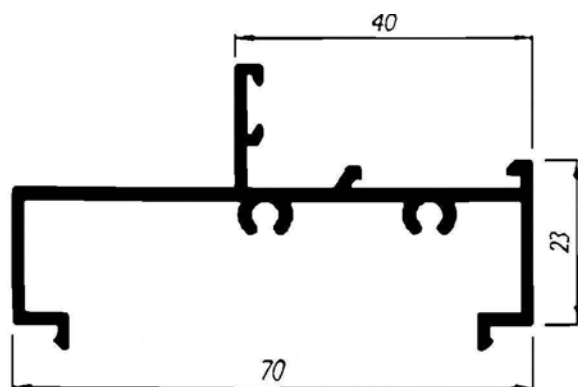

28125 MARCO FIJO DE CLIPAR

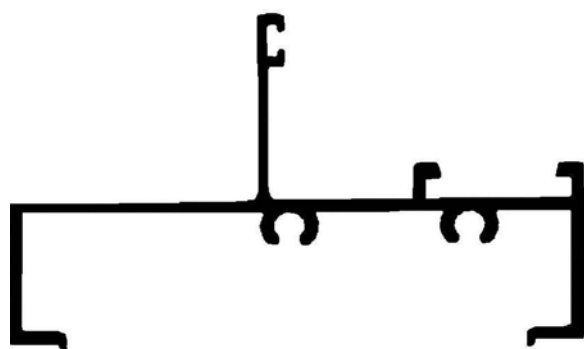

CMD626 MARCO FIJO LISO C.EUROPEO

**CORREDERA G-90**

**norperfil**

**HOJAS**

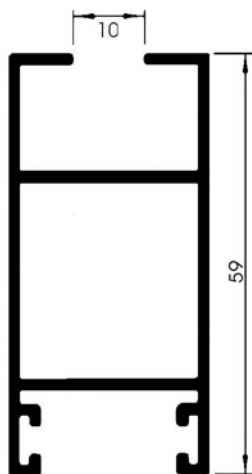

**28065**

HOJA LATERAL CRISTAL NORMAL

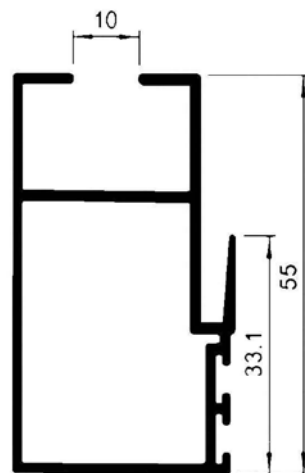

**28085**

HOJA CENTRO CRISTAL NORMAL

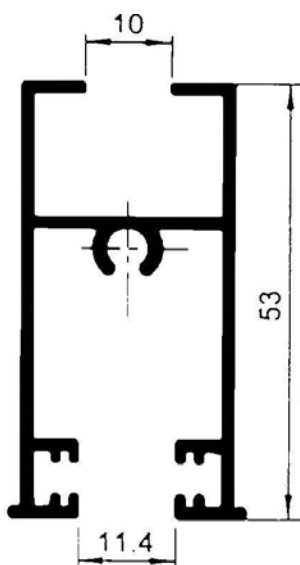

**28045**

HOJA RULETA CRISTAL NORMAL

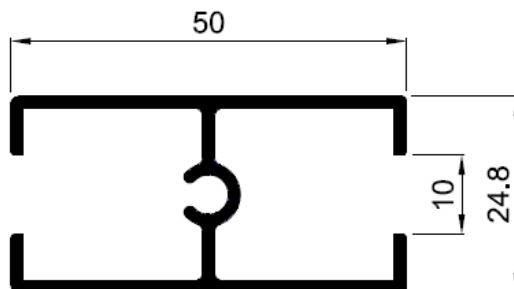

**28022**

DIVISION HOJA CRISTAL NORMAL



**CORREDERA G-90**

**norperfil**

**HOJAS**

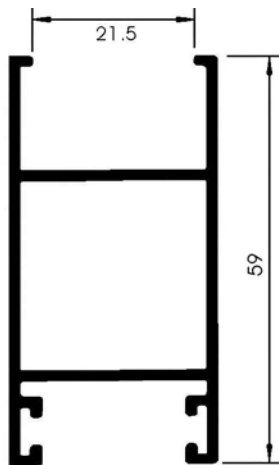

**28075**

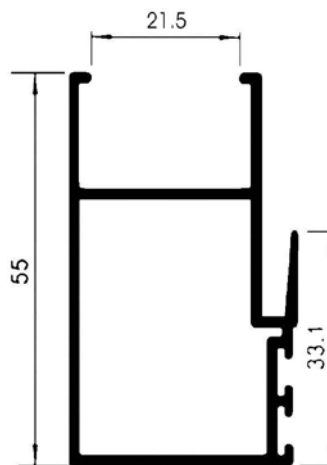

**28095**

**HOJA LATERAL CLIMALIT**

**HOJA CENTRO CLIMALIT**

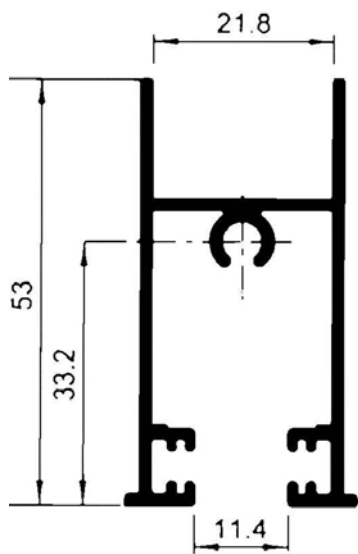

**28055**

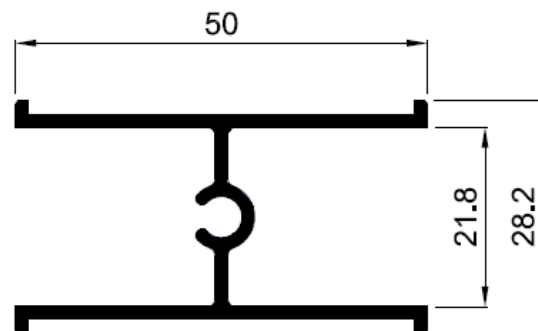

**28021**

**HOJA RULETA CLIMALIT**

**DIVISION HOJA CLIMALIT**

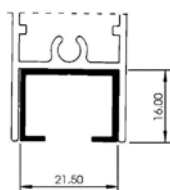

**28003** **ADAPTADOR CRISTAL NORMAL**

**CORREDERA G-90**

**norperfil**

ZOCALOS -DIVISIONES

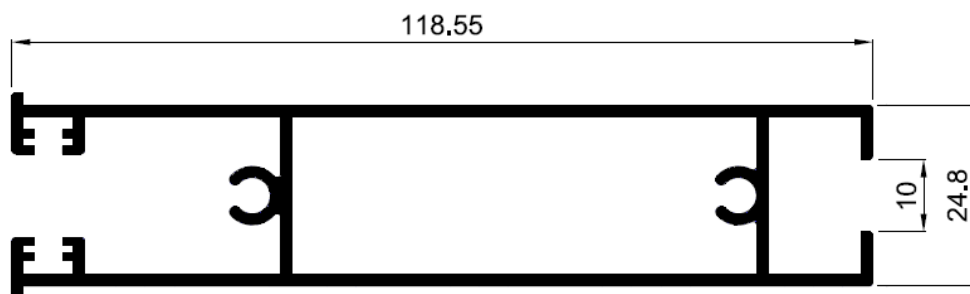

**28087** ZOCALO RULETA CRISTAL NORMAL

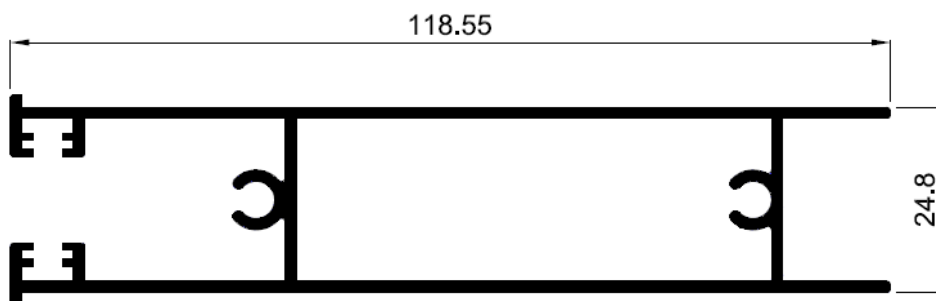

**28088** ZOCALO RULETA CLIMALIT

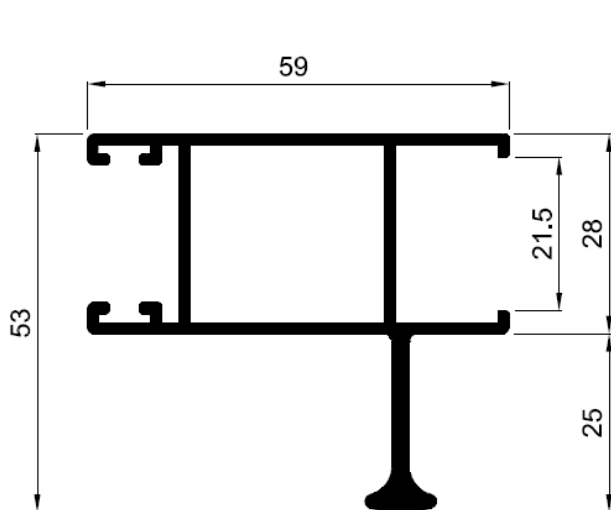

**28353**

HOJA LATERAL REFORZADA CLIMALIT

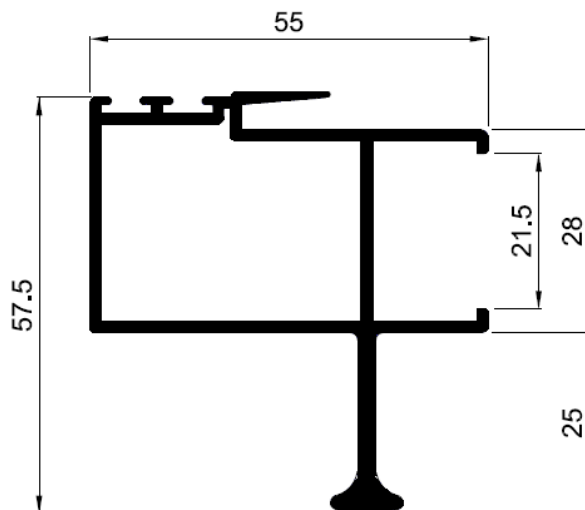

**28328**

HOJA CENTRO REFORZADA CLIMALIT

ALARGADERAS- CONDENSACIONES

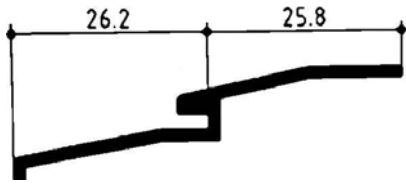

28051

ALARGADERA DE 52 mm

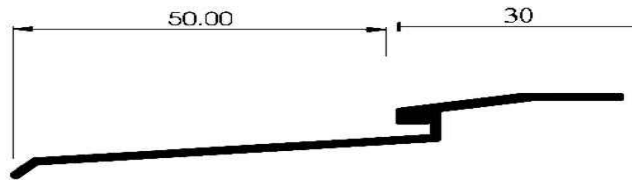

28081

ALARGADERA DE 80mm

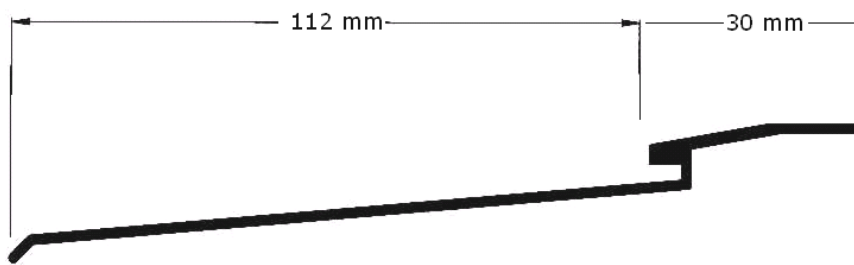

28121

ALARGADERA DE 142mm

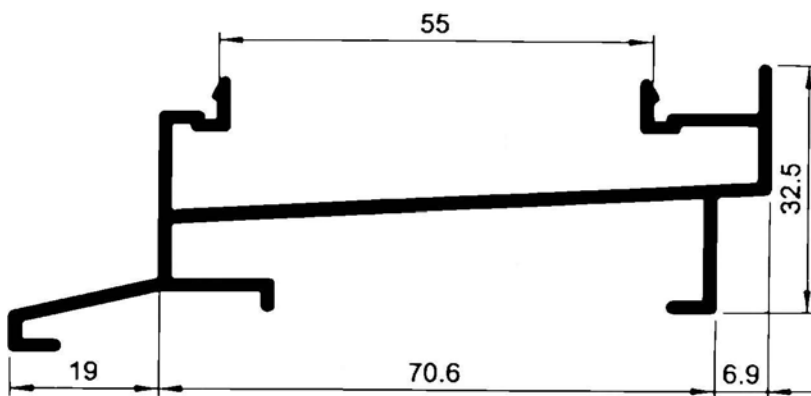

28135 CONDENSACION MAINEL LISO

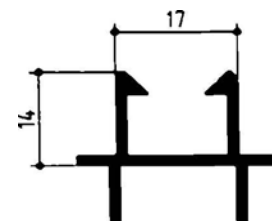

28004

PERFIL 4 HOJAS

ESQUINERO - UNIONES

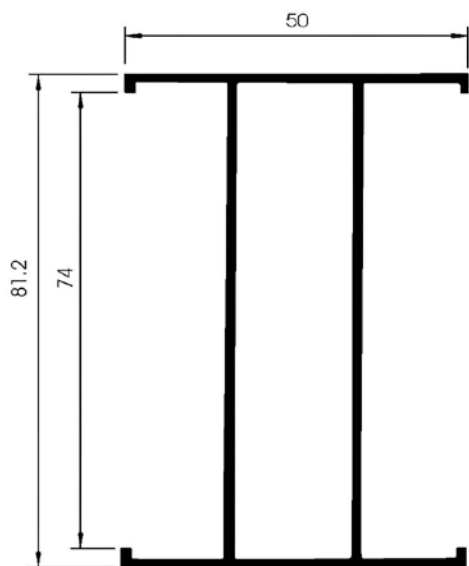

**CMD1059**

UNION DE MARCOS TUBULAR

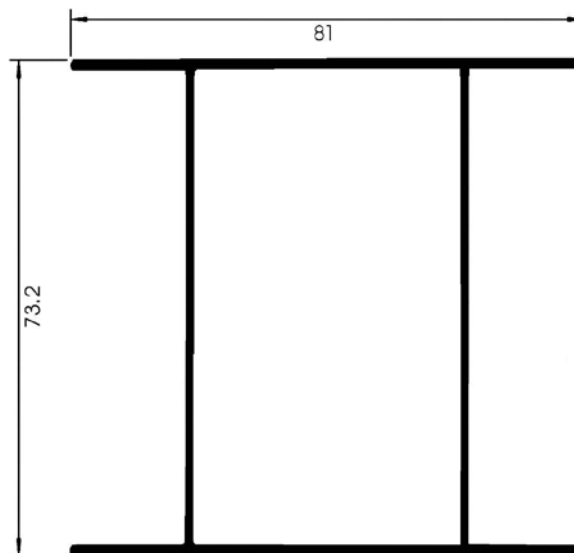

**CMD860**

UNION DE MARCOS PARA RESALTE

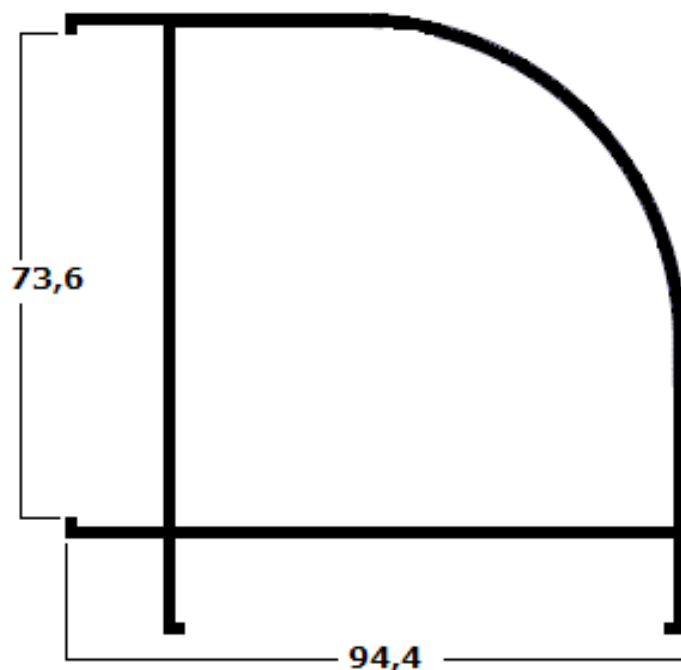

**CMD1060** ESQUINERO REDONDO DE 90°

3 CARRILES

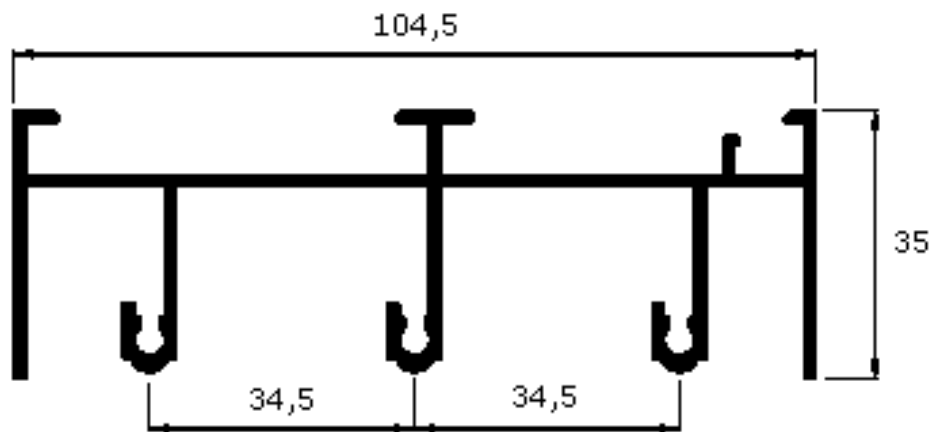

**28324** MARCO SUPERIOR 3 CARRILES

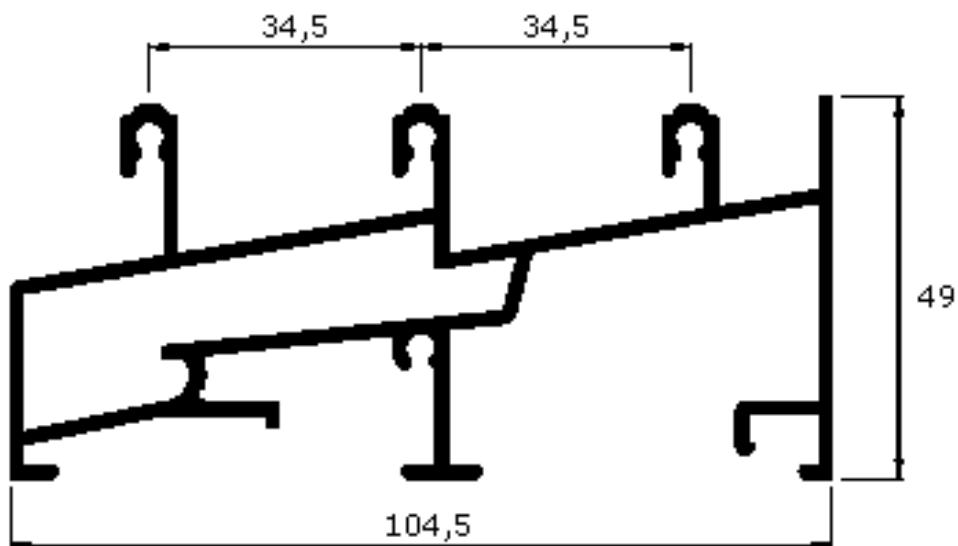

**28325** MARCO INFERIOR 3 CARRILES

**CORREDERA G-90**

**norperfil**

3 CARRILES

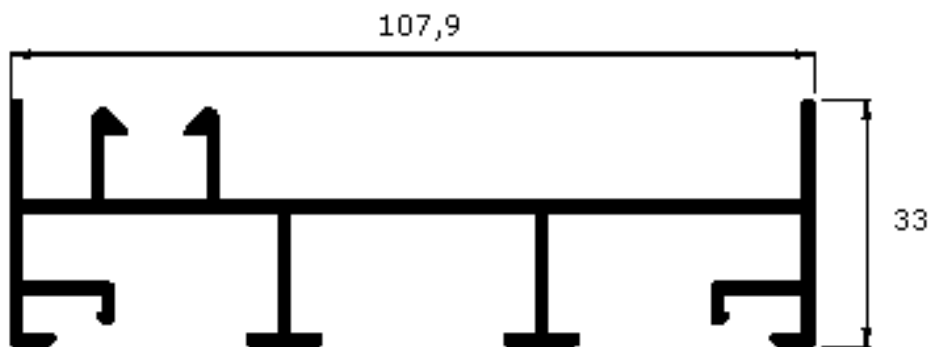

**28326** MARCO LATERAL 3 CARRILES

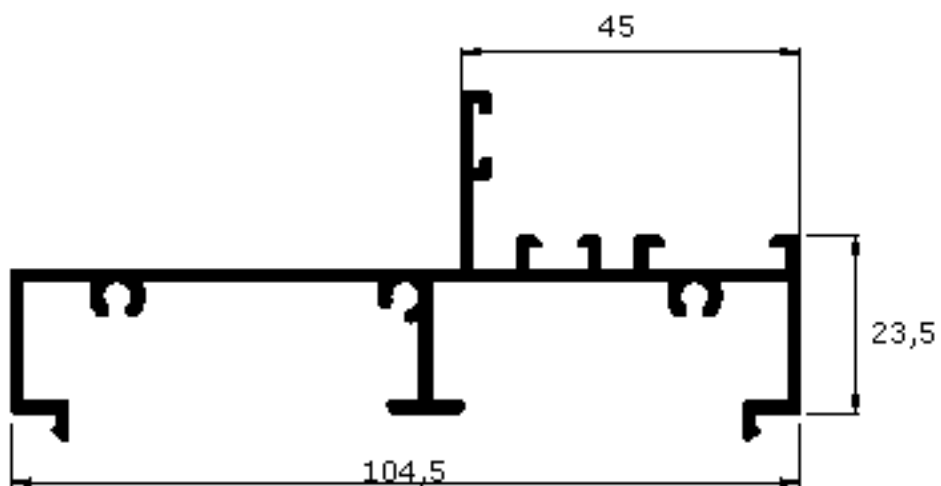

**28433** MARCO FIJO CLIPAR 3 CARRILES

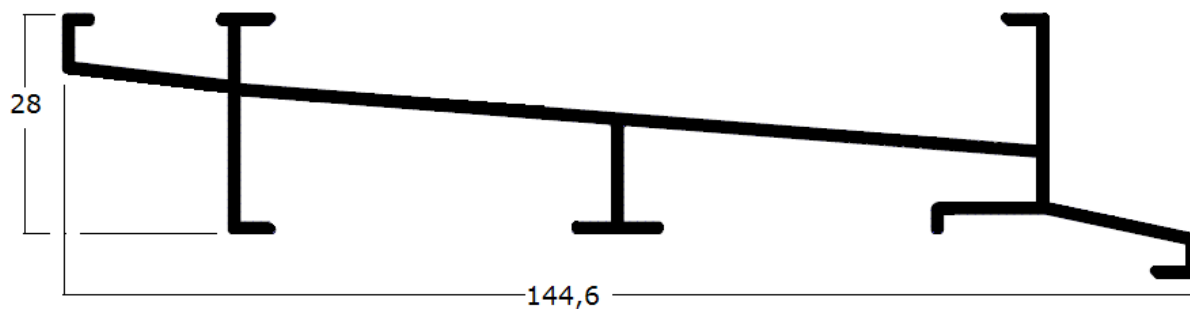





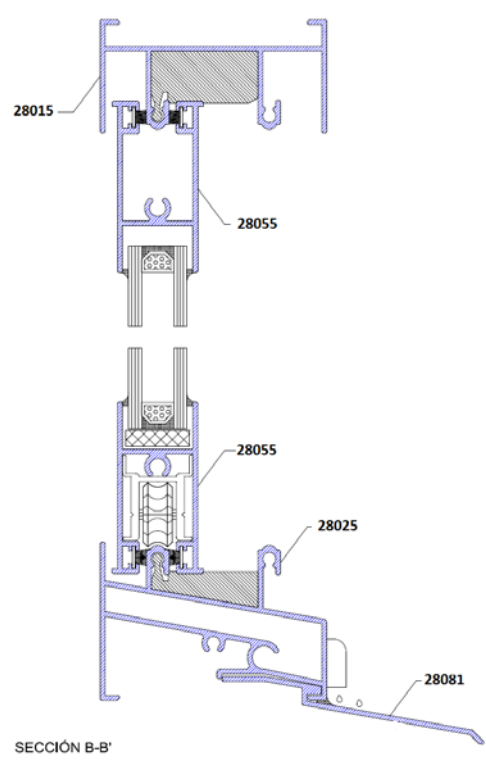
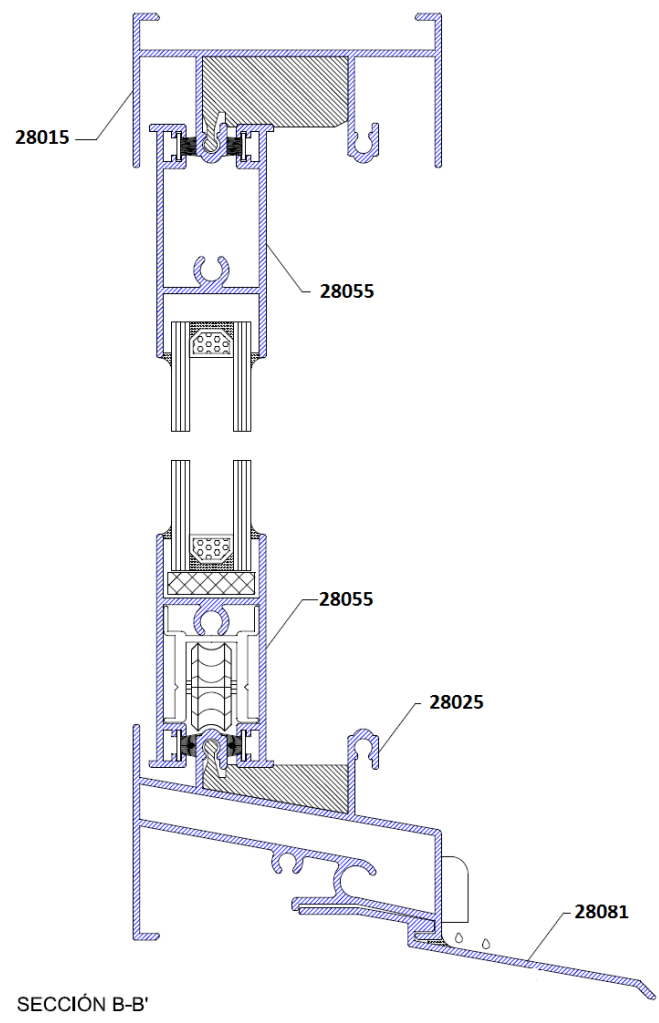
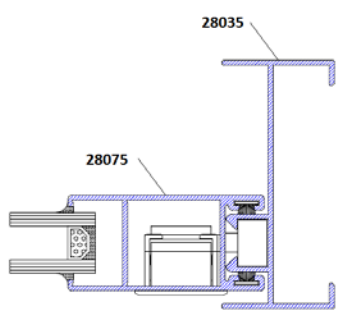
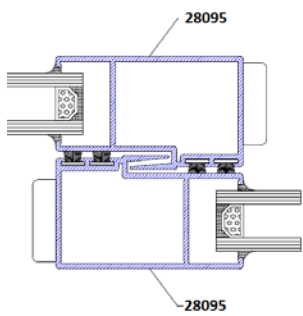
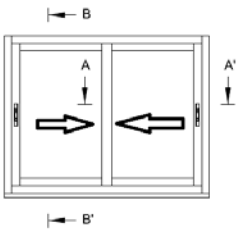

**28134** CONDENSACION MAINEL 3 CARRILES

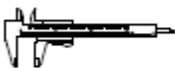
# CORREDERA G-90

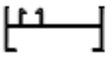
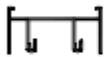
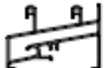
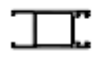
norperfil







CROQUIS	REF.:	DESCRIPCIÓN		
	<b>28035</b>	marco lateral	<b>H</b>	2 Unidades
	<b>28015</b>	marco superior	<b>L - 40</b>	1 Unidad
	<b>28025</b>	marco inferior	<b>L - 40</b>	1 Unidad
	<b>28075</b>	hoja lateral	<b>H - 68</b>	2 Unidades para 2 hojas 2 Unidades para 3 hojas 4 Unidades para 4 hojas
	<b>28095</b>	hoja central	<b>H - 68</b>	2 Unidades para 2 hojas 4 Unidades para 3 hojas 4 Unidades para 4 hojas
	<b>28055</b>	hoja ruleta	<b>L/2 - 10</b> <b>L/3 + 9.2</b> <b>L/3 + 18.4</b>	4 Unidades para 2 hojas 4 Unidades para 3 hojas 2 Unidades para 3 hojas
	<b>28004</b>	acople 4 hojas	<b>L/4 + 2</b> <b>H - 68</b>	8 Unidades para 4 hojas 1 Unidad

**DESCUENTOS (S/G - 90, 3 CARRILES)**

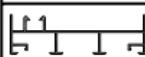
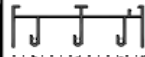
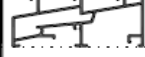
*H = ALTURA DE MARCO*

*L = ANCHO DE MARCO*

CROQUIS	REF.:	DESCRIPCIÓN	M. CORTE	OBSERVACIONES
	28326	<i>M. LATERAL</i>	<b>H</b>	2 Unidades
	28324	<i>M. SUPERIOR</i>	<b>L - 40</b>	1 Unidad
	28325	<i>M. INFERIOR</i>	<b>L - 40</b>	1 Unidad
	28075	<i>H. LATERAL</i>	<b>H - 68</b>	2 Unidades
	28095	<i>H. CENTRAL</i>	<b>H - 68</b>	4 Unidades
	28055	<i>H. RULETA</i>	<b>L/3 + 9.2</b>	4 Unidades
	28055	<i>H. RULETA</i>	<b>L/3 + 18.4</b>	2 Unidades